

TOPLOADER

TECHNOLOGY FOR A SUSTAINABLE TOMORROW

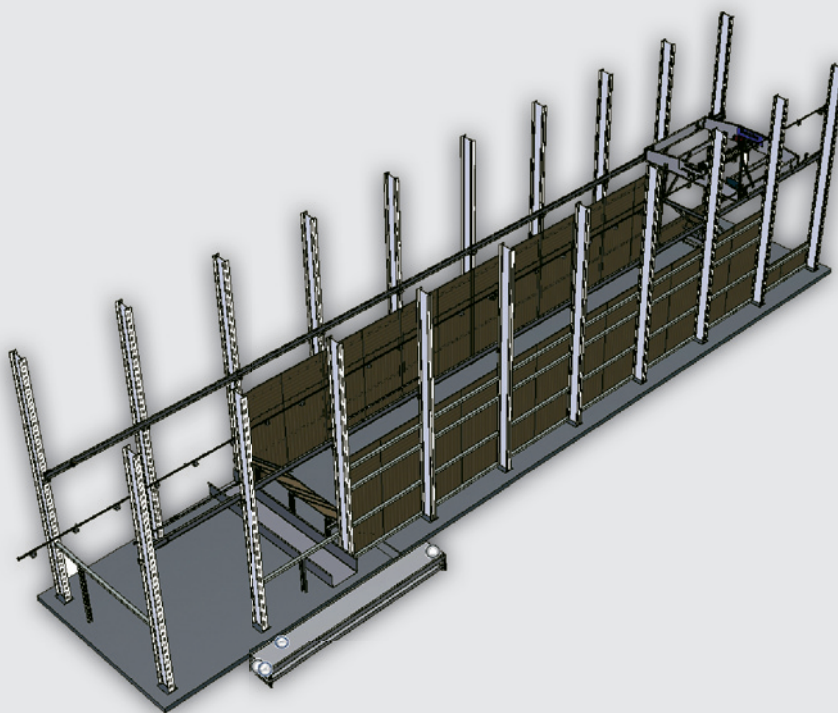

▲
Storing



APPLICATION

The VECOPLAN Toploader is the economical solution for an automaticated storing and conveying system for bulk materials like peat, composit, wood chips, fertiliser, fibre, saw dust, bark, RDF or old timber (max. particle size 300 mm).

The patented Toploader-system assures a fully automatically box discharge without any operator. One or more boxes are filled from the open side to an even bottom area. The material is discharged by the Toploader, a shovel provided with guide bars and hooked on one side that is mounted on a moveable sleigh.

Drive, hoisting device and mechanical components are situated outside of the material, for easy access and maintenance.

Vecoplan[®]

TOPLOADER

TECHNOLOGY FOR A SUSTAINABLE TOMORROW



Storing

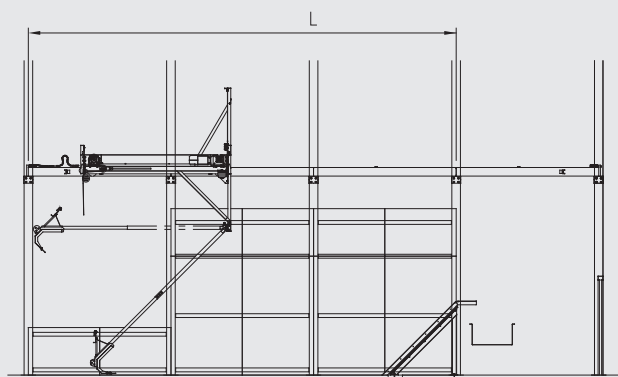

Side view

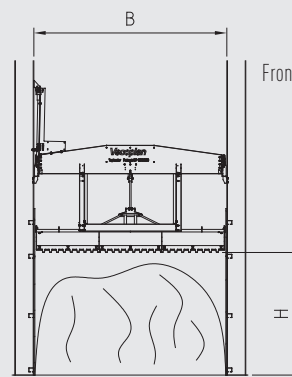

Front view

Example calculation:

Length of silo 12 m, width of bucket 4 m, conveying velocity 24 m/min. = 30 m³

$$\text{Conveying capacity} = \frac{\text{Conveying velocity}}{\text{Length of silo} \times 2} \times 60 \times \frac{\text{Volume}}{\text{Width of bucket}}$$

$$\text{Conveying capacity} = \frac{24}{12 \times 2} \times 60 \times 0,5$$

DETAILS

		Toploader 4 x 12 m	Toploader 5 x 12 m	Toploader 6 x 12 m
Width of box (B)	mm	4.000	5.000	6.000
Length of box (L)	mm	12.000 (optional extension every 1m)		
Fill depth (H)	mm	2.500	2.500	2.500
Storing volume	m ³	120 (every m + 10m ³)	150 (every m + 12,5m ³)	180 (every m + 15m ³)

Subject to technical changes without notice / Detailed dimension drawings and load data available on request / Dated: 04/2012